

# Ball screws Peeled

## 3.6 Simple cylindrical nut ZE

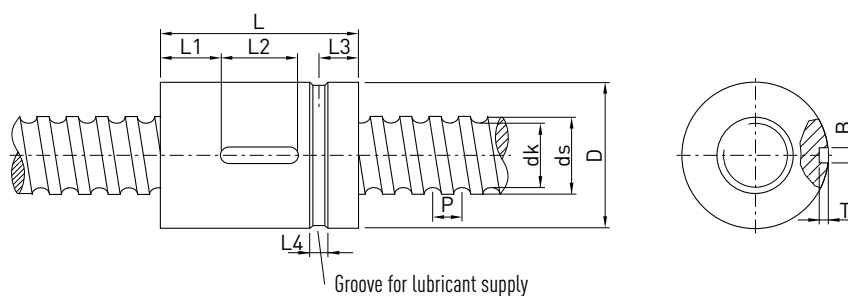

| Nut type      | ds | P  | D<br>g7 | L<br>±0.2 | L1   | L2 | L3 | L4 | T<br>+0.1 | B<br>P9 | dk   | Dyn. capacity<br>C <sub>dyn</sub> [N] | Stat. capacity<br>C <sub>0</sub> [N] | Nut weight<br>[kg/ks] |
|---------------|----|----|---------|-----------|------|----|----|----|-----------|---------|------|---------------------------------------|--------------------------------------|-----------------------|
| ZE1605-R-3EF  | 16 | 5  | 28      | 40        | 12   | 16 | 9  | 4  | 2.4       | 4       | 13.5 | 9600                                  | 12700                                | 0.10                  |
| ZE2005-R-4EF  | 20 | 5  | 36      | 51        | 15   | 20 | 10 | 4  | 2.4       | 4       | 17.5 | 13900                                 | 21800                                | 0.23                  |
| ZE2505-R-4EF  | 25 | 5  | 40      | 60        | 20   | 20 | 12 | 5  | 2.4       | 4       | 22.5 | 15600                                 | 27900                                | 0.29                  |
| ZE2510-R-3EF  | 25 | 10 | 48      | 65        | 22   | 20 | 15 | 5  | 2.4       | 4       | 21.0 | 24100                                 | 36200                                | 0.50                  |
| ZE3205-R-5EF  | 32 | 5  | 48      | 60        | 20   | 20 | 12 | 5  | 2.4       | 4       | 29.5 | 20700                                 | 43900                                | 0.38                  |
| ZE3210-R-4EF  | 32 | 10 | 56      | 80        | 27   | 25 | 15 | 5  | 2.4       | 4       | 27.8 | 40900                                 | 63200                                | 0.74                  |
| ZE3220-R-2EB  | 32 | 20 | 56      | 80        | 27   | 25 | 15 | 5  | 2.4       | 4       | 27.8 | 20300                                 | 26800                                | 0.70                  |
| ZE4005-R-5EF  | 40 | 5  | 56      | 68        | 24   | 20 | 15 | 6  | 2.4       | 4       | 37.5 | 22500                                 | 54600                                | 0.44                  |
| ZE4010-R-4EF  | 40 | 10 | 62      | 88        | 31   | 25 | 15 | 6  | 2.4       | 4       | 35.8 | 46800                                 | 82600                                | 0.85                  |
| ZE4020-R-2EB  | 40 | 20 | 62      | 88        | 31   | 25 | 15 | 6  | 2.4       | 4       | 35.8 | 23800                                 | 36400                                | 0.88                  |
| ZE4040-R-2GB  | 40 | 40 | 72      | 118       | 46   | 25 | 29 | 6  | 2.4       | 4       | 35.8 | 23800                                 | 42900                                | 1.80                  |
| ZE5005-R-5EF  | 50 | 5  | 68      | 69        | 24   | 20 | 15 | 6  | 2.4       | 4       | 47.5 | 24900                                 | 69800                                | 0.72                  |
| ZE5010-R-4EF  | 50 | 10 | 72      | 100       | 37   | 25 | 17 | 6  | 2.4       | 4       | 45.8 | 52800                                 | 106800                               | 1.04                  |
| ZE5020-R-3EB  | 50 | 20 | 72      | 114       | 44   | 25 | 17 | 6  | 2.4       | 4       | 45.8 | 40000                                 | 76200                                | 1.10                  |
| ZE6310-R-6EF  | 63 | 10 | 85      | 120       | 44   | 32 | 17 | 6  | 3.5       | 6       | 58.8 | 84700                                 | 210800                               | 1.73                  |
| ZEN6320-R-4EP | 63 | 20 | 95      | 135       | 52   | 32 | 17 | 6  | 3.5       | 6       | 55.4 | 105000                                | 250000                               | 3.80                  |
| ZE8010-R-6EF  | 80 | 10 | 105     | 120       | 44   | 32 | 17 | 8  | 3.5       | 6       | 75.8 | 93400                                 | 269200                               | 2.80                  |
| ZE8020-R-4EP  | 80 | 20 | 125     | 150       | 52   | 45 | 17 | 8  | 3.5       | 6       | 72.4 | 135000                                | 322000                               | 7.80                  |
| ZEH8020-R-6EP | 78 | 20 | 130     | 182       | 68.5 | 45 | 19 | 8  | 4.0       | 8       | 68.2 | 200000                                | 510000                               | 11.00                 |

Dimensions in [mm]

- Nuts for peeled ball screws
- Accuracy class P5 and P7