

Ball screws

Peeled

3.8 Simple cylindrical nut with thread SE

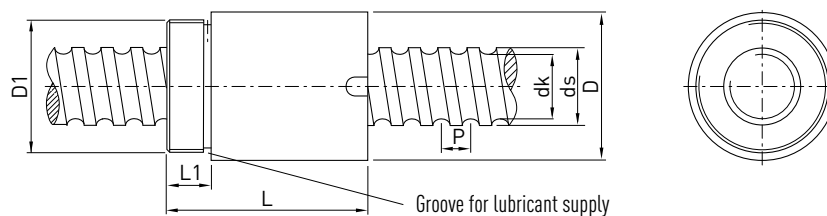

Nut type	ds	P	D -0.2	D1	L -0.5	L1	dk	Dyn. capacity C _{dyn} [N]	Stat. capacity C ₀ [N]	Nut weight [kg/ks]
SE1605-R-3EF	16	5	36	M30x1.5	42	12	13.5	9600	12700	0.45
SE2005-R-4EF	20	5	40	M35x1.5	52	12	17.5	13900	21800	0.53
SE2505-R-4EF	25	5	45	M40x1.5	60	15	22.5	15600	27900	0.82
SE2510-R-3EF	25	10	48	M45x1.5	70	15	21.0	24100	36200	1.00
SE3205-R-5EF	32	5	52	M48x1.5	60	15	29.5	20700	43900	1.13
SE3210-R-4EF	32	10	56	M52x1.5	90	15	27.8	34100	56100	1.62
SE3220-R-2EB	32	20	56	M52x1.5	80	15	27.8	20300	26800	1.44
SE4005-R-5EF	40	5	65	M60x1.5	68	18	37.5	22500	54600	1.63
SE4010-R-4EF	40	10	65	M60x1.5	88	18	35.8	46800	82600	1.75
SE4020-R-2EB	40	20	65	M60x1.5	88	18	35.8	23800	36400	1.75
SE5010-R-4EF	50	10	80	M75x1.5	100	20	45.8	52800	106800	2.96
SE5020-R-3EB	50	20	80	M75x1.5	114	20	45.8	40000	76200	3.15
SE6310-R-6EF	63	10	95	M85x2.0	120	20	58.8	84700	210800	4.37
SE6320-R-3EP	63	20	95	M85x2.0	138	20	55.4	96000	189000	4.40

Dimensions in [mm]

- Nut for peeled ball screws
- Accuracy class P5 and P7