

Ball screws Peeled

3.7 Double preloaded cylindrical nut ZD

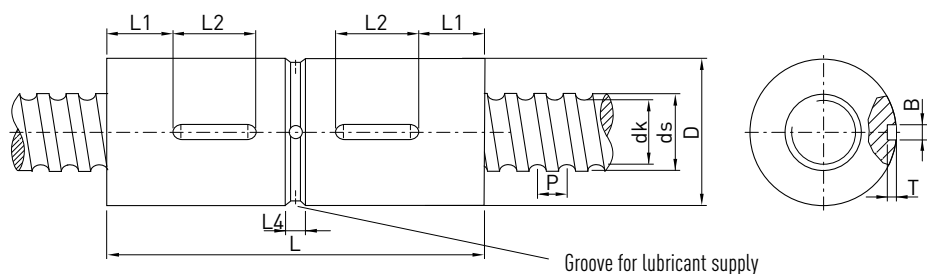

Nut type	ds	P	D g7	L ±0.2	L1	L2	L4	T +0.1	B P9	dk	Dyn. capacity C _{dyn} [N]	Stat. capacity C ₀ [N]	Nut weight [kg/ks]
ZD1605-R-3EF	16	5	28	72	14	16	4	2.4	4	13.5	9600	12700	0.20
ZD2005-R-4EF	20	5	36	86	15	20	4	2.4	4	17.5	13900	21800	0.39
ZD2505-R-4EF	25	5	40	100	20	20	5	2.4	4	22.5	15600	27900	0.48
ZD2510-R-3EF	25	10	48	115	20	20	5	2.4	4	21.0	24100	36200	0.80
ZD3205-R-5EF	32	5	48	100	20	20	5	2.4	4	29.5	20700	43900	0.63
ZD3210-R-3EF	32	10	56	136	25	25	6	2.4	4	27.8	32000	47500	1.30
ZD3220-R-2EB	32	20	56	142	28	25	6	2.4	4	27.8	20300	26800	1.30
ZD4005-R-5EF	40	5	56	108	20	20	6	2.4	4	37.5	22500	54600	0.78
ZD4010-R-4EF	40	10	62	142	28	25	6	2.4	4	35.8	46800	82600	1.34
ZD4020-R-2EB	40	20	62	146	30	25	6	2.4	4	35.8	23800	36400	1.51
ZD5005-R-5EF	50	5	68	108	20	20	6	2.4	4	47.5	24900	69800	1.40
ZD5010-R-4EF	50	10	72	168	35	25	8	2.4	4	45.8	52800	106800	1.72
ZD5020-R-3EB	50	20	72	190	47	25	6	2.4	4	45.8	40000	76200	1.95
ZD6310-R-6EF	63	10	85	208	44	32	6	3.5	6	58.8	84700	210800	2.81
ZDN6320-R-4EP	63	20	95	260	65	32	6	3.5	6	55.4	105000	250000	7.30
ZD8010-R-6EF	80	10	105	208	44	32	6	3.5	6	75.8	93400	269200	5.50
ZD8020-R-4EP	80	20	125	285	55	32	8	4.1	8	72.4	135000	322000	14.90

Dimensions in [mm]

- Nuts for peeled ball screws
- Standard preload 7% C_{dyn}
- Accuracy class P5 and P7