

**SYK<sup>®</sup>**  
**HIWIN<sup>®</sup>**  
Motion Control & Systems

Technical drawing of a mechanical part, likely a bracket or support, showing dimensions and labels:

- Overall width: 95
- Distance from left edge to center of top hole: 75
- Distance from left edge to center of bottom hole: 47.5
- Distance from center of top hole to center of bottom hole: 50
- Distance from center of bottom hole to bottom edge: E
- Distance from center of bottom hole to right edge: L
- Labels: U (upward arrow), E (edge), L (length), and U (upward arrow).
- Bottom text: 4- $\phi 11$  drill  $\phi 17$  counter bore depth



Surface treatment:  
Black Oxide / Electroless Nickel Plating

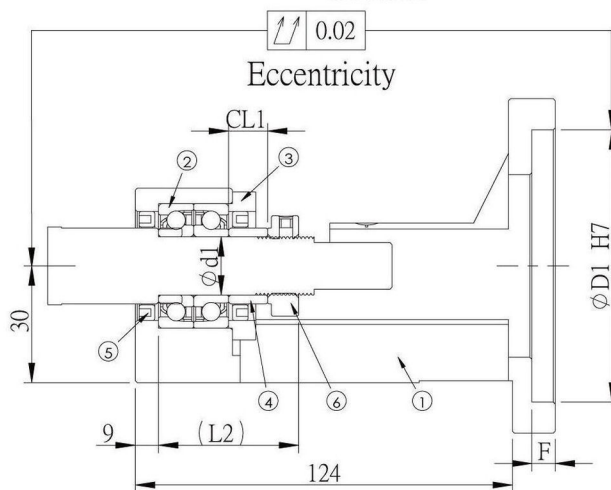
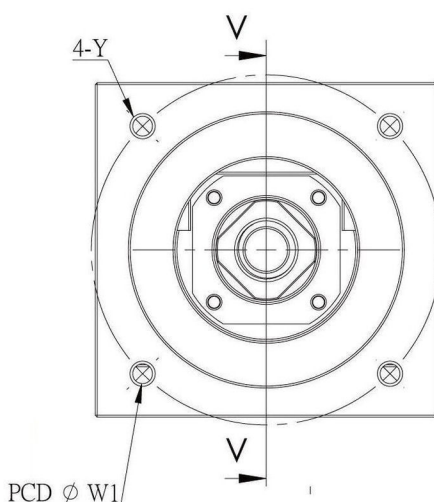
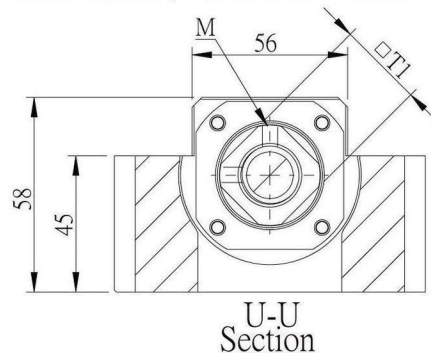

Model No.	D1	W1	Y	L	Shaft diameter d1	CL1	L2	E	F	M	T1	Weight (Kgs)	Support unit	Suggest Coupling
													Supported-side	
MBCS15-X	80	100	M6	140	15	9	47	70	8	2-M4	□22	-	AF 15 EF 15	SGS 50C
MBCS15-Y	95	115	M8	141				SGS 50C						
MBCS15-YP			M6	SGS 57C										
MBCS15-S	110	130	M8	151				SQL 57C						
MBCS15-G		145		153				SGS 57C						

2.DF type, P4 grade preloaded duplex angular contact ball bearing suitable for ballscrew use.