

Ball screws

Rolled

2.7 Simple cylindrical nut with thread RSIT for small diameters

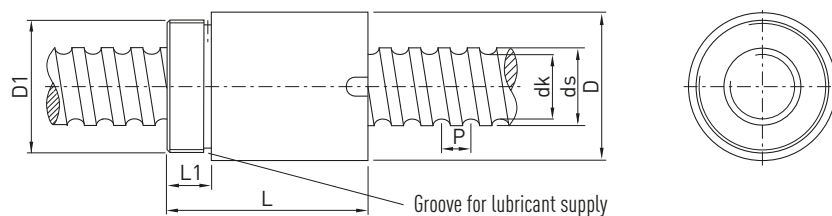

Nut type	Size	ds	P	D -0.2	D1	L -0.5	L1	dk	Dyn. capacity C _{dyn} [N]	Stat. capacity C ₀ [N]	Max. axial play [mm]	Nut weight [kg]	Shaft weight [kg/m]	Accuracy class T5
R08-25T2-RSIT**	8x2.5	7.7	2.5	17.5	M15x1	27.5	7.5	6.1	1300	1750	0.04	0.04	0.33	-
R10-25T2-RSIT*	10x2.5	9.9	2.5	19.5	M17x1	25.0	7.5	8.1	1780	2630	0.04	0.06	0.62	-
R10-04-T2-RSIT *	10x4	9.9	4.0	24.0	M22x1	32.0	10.0	7.7	1980	2820	0.04	0.08	0.62	-
R12-04B1-RSIT**	12x4	12.0	4.0	25.5	M20x1	34.0	10.0	9.5	3000	5700	0.04	0.10	0.71	-

Dimensions in [mm]

○ Standard accuracy class T7

* without sealing

** one side sealing