

Ball screws Shaft ends

6.3 Standard shaft end E2B for BK fixed bearing housing

Type E2B1

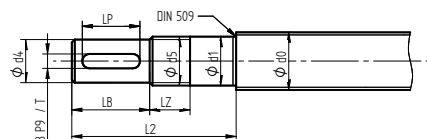

Type E2B2

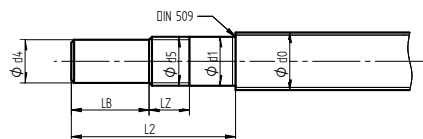

Type E2B3

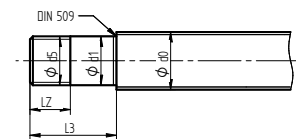

Dimensional table of E2B shaft end for BK bearing housing

Type	Bearing housing	d0	d1	d4	d5	LB	LZ	L2	L3	LP	B x T
E2B_-10	BK-10	12	10 h6	8 j6	M10x1	15	16	51	36	9	2x1.2
E2B_-12	BK-12	16	12 h6	10 j6	M12x1	15	14	51	36	9	3x1.8
E2B_-15	BK-15	20	15 h6	12 j6	M15x1	20	12	60	40	12	4x2.5
E2B_-17	BK-17	25	17 h6	15 j6	M17x1	23	17	76	53	15	5x3.0
E2B_-20	BK-20	25	20 h6	17 j6	M20x1	25	15	78	53	15	5x3.0
E2B_-25	BK-25	32	25 h6	20 j6	M25x1.5	30	18	95	65	16	6x3.5
E2B_-30	BK-30	40	30 h6	25 j6	M30x1.5	38	25	110	72	23	8x4.0
E2B_-40	BK-40	50	40 h6	35 j6	M40x1.5	50	35	143	83	26	10x5.0

Dimensions in [mm]

6.4 Standard shaft end E5B for BF simple bearing housing

Type E5B

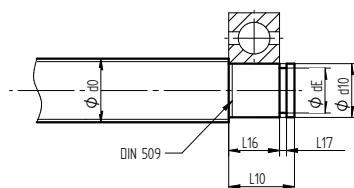

Dimensional table for E5B shaft end for BF bearing housing

Type	Bearing housing	d0	d10 j6	dE -0.2	L10	L16	L17 H13
E5B-10	BF-10	12	8	7.6	10	7	0.9
E5B-12	BF-12	16	10	9.6	11	8	1.15
E5B-15	BF-15	20	15	14.3	13	9	1.15
E5B-17	BF-17	25	17	16.2	16	12	1.15
E5B-20	BF-20	25	20	19.0	16	12	1.35
E5B-25	BF-25	32	25	23.9	20	15	1.35
E5B-30	BF-30	40	30	28.6	21	16	1.75
E5B-40	BF-40	50	40	38.0	23	18	1.95

Dimensions in [mm]