

Linear Guideways

RG/QR series

3.6.10 Dimensions of the RG rail

The RG rails are used for both the RG and QR blocks.

3.6.10.2 Dimensions RGR_T (rail mounting from below)

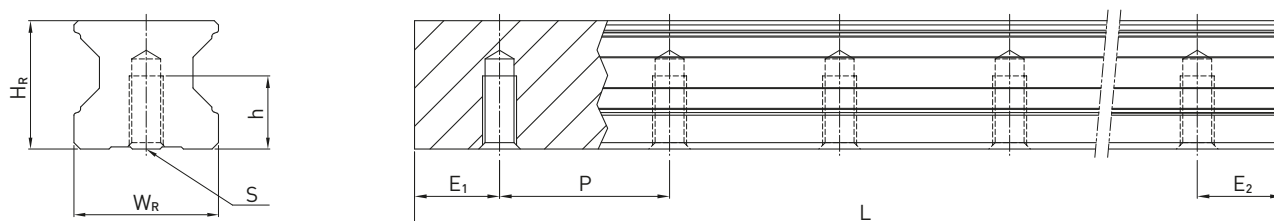

Table 3.109 Dimensions of rail RGR_T

Series/ size	Dimensions of rail [mm]					Max. length [mm]	Max. length $E_1 = E_2$ [mm]	Min. length [mm]	$E_{1/2}$ min [mm]	$E_{1/2}$ max [mm]	Weight [kg/m]
	W_R	H_R	S	h	P						
RGR15T	15	16.5	M5	8.0	30.0	4.000	3.960.0	72	6	24.0	1.86
RGR20T	20	21.0	M6	10.0	30.0	4.000	3.960.0	74	7	23.0	2.76
RGR25T	23	23.6	M6	12.0	30.0	4.000	3.960.0	76	8	22.0	3.36
RGR30T	28	28.0	M8	15.0	40.0	4.000	3.920.0	98	9	31.0	4.82
RGR35T	34	30.2	M8	17.0	40.0	4.000	3.920.0	98	9	31.0	6.48
RGR45T	45	38.0	M12	24.0	52.5	4.000	3.937.5	129	12	40.5	10.83
RGR55T	53	44.0	M14	24.0	60.0	4.000	3.900.0	148	14	46.0	15.15
RGR65T	63	53.0	M20 ¹⁾	30.0	75.0	4.000	3.900.0	180	15	60.0	21.24

¹⁾ Deviating from DIN 645

Note:

1. The tolerance for E is +0.5 to - 1 mm for standard rails and 0 to - 0.3 mm for joints.
2. If the $E_{1/2}$ dimensions are not indicated, the maximum possible number of mounting holes will be determined under consideration of $E_{1/2}$ min.
3. The rails are shortened to the required length. If the $E_{1/2}$ dimensions are not indicated, these will be carried out symmetrically.