

Ball screws

Shaft ends

6.5 Standard shaft end E2E for EK fixed bearing housing

Type E2E1

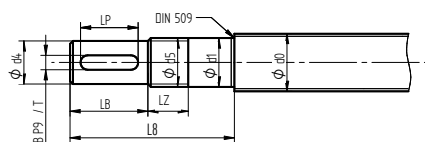

Type E2E2

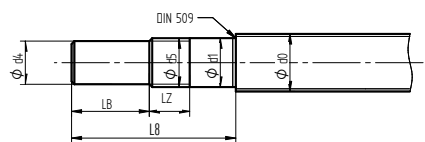

Type E2E3

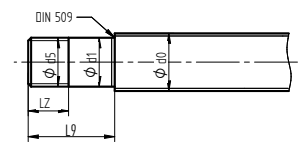

Dimensional table of E2E shaft end for EK bearing housing

| Type | Bearing housing | d0 | d1 | d4 | d5 | LB | LZ | L8 | L9 | LP | B x T |
|---------|-----------------|---------|------|------|---------|----|----|----|----|----|-------|
| E2E_-06 | EK-06 | 8, 10* | 6 h6 | 4 j6 | M6x0.75 | 8 | 8 | 36 | 28 | - | - |
| E2E_-08 | EK-08 | 10*, 12 | 8 h6 | 6 j6 | M8x1 | 9 | 10 | 41 | 32 | 6 | 2x1.2 |

*E2E_-06 suitable for ball screws 10x4

E2E_-08 suitable for ball screws 10x2.5

Dimensions in [mm]

6.6 Standard shaft end E5E for EF simple bearing housing

Type E5E

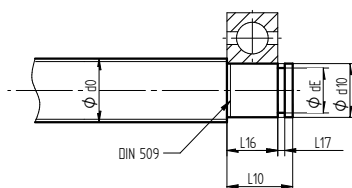

Dimensional table for E5E shaft end for EF bearing housing

| Type | Bearing housing | d0 | d10 j6 | dE -0.2 | L10 | L16 | L17 H13 |
|--------|-----------------|---------|--------|---------|-----|-----|---------|
| E5E-06 | EF-06 | 8,10* | 6 | 5.7 | 9 | 6 | 0.8 |
| E5E-08 | EF-08 | 10*, 12 | 6 | 5.7 | 9 | 6 | 0.8 |

*E5E_-06 suitable for ball screws 10x4

E5E_-08 suitable for ball screws 10x2.5

Dimensions in [mm]